

Professional Breathalyzer



AT8900 Professional Breathalyzer

FEATURES

- Fuel cell sensor-accuracy and reliance
- Pre-calibrated sensor module-easy for maintenance
- Passive and active test
- Adjustable alarming threshold
- Anti-backflow mouthpiece for health and safety
- Colorful OLED indication and touch screen keyboard input
- 7.4V/2500 mAh Lithium battery
- Real temperature and time indication
- Switchable result units(mg/l, g/l, %BAC, ‰BAC)and temperature scale(°C, °F)
- Testing records (maximum 20000) review
- Password management
- Built-in printer and data uploading

APPLICATION:

Police station, traffic management, factory, workshop, office, car, hotel, mine, etc.

MENU OPERATION

In the standby interface shown as below, click the menu icon on the screen to enter the corresponding menu item. Partial menu operation requires password authentication.

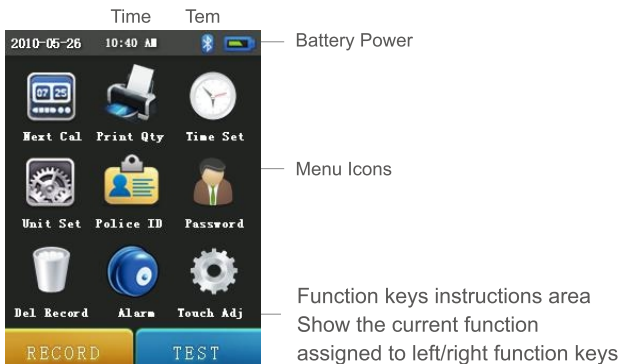

RECORD UPLOAD

The back-up management on computer requires cooperation of software.



SPECIFICATIONS

Sensor Type	Fuel cell	Display	2.8-inch touch screen
Detection Range	0.00 - 0.40%BAC; 0.00-4.00‰BAC 0.00 - 2.00mg/L; 0.00 - 4.00g/L	Power	7.4V/2500mAh Lithium batteries
		Working Environment	0°C - 50°C, ≤95% RH, No dews
Accuracy	± 0.005 at 0.05%BAC	Working Time	>20 hours non-stop (full charge)
Pre-set Level	0.05%BAC; 0.50‰BAC; 0.25mg/L; 0.50g/L	Charging Time	Four hours
		Dimensions	185mm*76mm*38mm @350g
Warm-up Time	<10 seconds	Records	20,000
Testing Time	< 5 Sec	Option	Built-in bluetooth thermal printer

Welcome to Hanwei !



汉威科技集团股份有限公司
Hanwei Electronics Group Corporation

ADD: No.169 Xuesong Road,National&HighTech Zone,
Zhengzhou 450001, Henan, China P.C: 450001

www.hwsensor.com

TEL: 86-371-67169070 / 80

FAX: 86-371-67169090

E-mail: sales@hwsensor.com